

Bucins Plásticos - Porcas Plásticas - Wiska



BUCIM PLÁSTICO - TIPO SKV



RAL 7035



RAL 9005

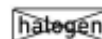
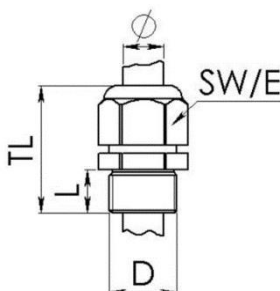

- ✓ Material: Bucim = Poliamida, Junta = EPDM
- ✓ Temperatura admissível: -40° C +100° C

Código	Referência	Tipo	Cor	L (mm)	D (mm)	Ø Cabo (mm)	SW (mm)	TL (mm)	
477010300	10066400	SKV 7	RAL 7035	9	PG 7	3-6	15	28-32	50
477010301	10066401	SKV 9	RAL 7035	9	PG 9	4-8	19	32-36	50
477010302	10066402	SKV 11	RAL 7035	9	PG 11	5-10	22	33-39	50
477010303	10066403	SKV 13,5	RAL 7035	10	PG 13,5	6-12	24	35-41	50
477010304	10066404	SKV 16	RAL 7035	11	PG 16	8-14	27	38-44	50
477010305	10066405	SKV 21	RAL 7035	11	PG 21	10-18	33	43-50	25
477010306	10066406	SKV 29	RAL 7035	12	PG 29	16-25	42	47-56	20
477010307	10066407	SKV 36	RAL 7035	14	PG 36	22-52	53	56-65	10
477010308	10066408	SKV 42	RAL 7035	14	PG 42	28-38	60	58-67	5
477010309	10066409	SKV 48	RAL 7035	15	PG 48	36-44	65	60-68	4
477010330	10066191	SKV 7	RAL 9005	9	PG 7	3-6	15	28-32	50
477010331	10066192	SKV 9	RAL 9005	9	PG 9	4-8	19	32-36	50
477010332	10066193	SKV 11	RAL 9005	9	PG 11	5-10	22	33-39	50
477010333	10066194	SKV 13,5	RAL 9005	10	PG 13,5	6-12	24	35-41	50
477010334	10066195	SKV 16	RAL 9005	11	PG 16	8-14	27	38-44	50
477010335	10066196	SKV 21	RAL 9005	11	PG 21	10-18	33	43-50	25
--	10066197	SKV 29	RAL 9005	12	PG 29	16-25	42	47-56	20
--	10066198	SKV 36	RAL 9005	14	PG 36	22-52	53	56-65	10
--	10066199	SKV 42	RAL 9005	14	PG 42	28-38	60	58-67	5
--	10066200	SKV 48	RAL 9005	15	PG 48	36-44	65	60-68	4

Nota: Também disponíveis no RAL 7001!

Bucins Plásticos - Porcas Plásticas - Wiska

PORCA PLÁSTICO HEXAGONAL - TIPO MUG

RAL 7035



RAL 9005

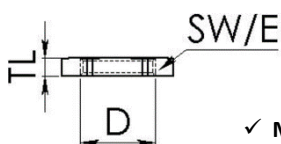



- ✓ Material: Poliamida reforçada com fibra
- ✓ Temperatura admissível: -40° C +100° C

Código	Referência	Tipo	Cor	D (mm)	SW (mm)	TL (mm)	
--	10060670	MUG 7	RAL 7035	PG 7	19	5	100
--	10060671	MUG 9	RAL 7035	PG 9	22	5	100
--	10060672	MUG 11	RAL 7035	PG 11	24	5	100
477011353	10060673	MUG 13,5	RAL 7035	PG 13,5	27	6	100
4770113341	10060674	MUG 16	RAL 7035	PG 16	30	6	100
--	10060675	MUG 21	RAL 7035	PG 21	36	7	100
--	10060676	MUG 29	RAL 7035	PG 29	46	7	50
--	10060677	MUG 36	RAL 7035	PG 36	60	8	25
--	10060678	MUG 42	RAL 7035	PG 42	65	8	25
--	10060679	MUG 48	RAL 7035	PG 48	70	8	10
477011330	10060680	MUG 7	RAL 9005	PG 7	19	5	100
477011331	10060681	MUG 9	RAL 9005	PG 9	22	5	100
477011332	10060682	MUG 11	RAL 9005	PG 11	24	5	100
477011333	10060683	MUG 13,5	RAL 9005	PG 13,5	27	6	100
477011334	10060684	MUG 16	RAL 9005	PG 16	30	6	100
477011335	10060685	MUG 21	RAL 9005	PG 21	36	7	100
477011336	10060686	MUG 29	RAL 9005	PG 29	46	7	50
477011337	10060687	MUG 36	RAL 9005	PG 36	60	8	25
477011338	10060688	MUG 42	RAL 9005	PG 42	65	8	25
477011339	10060689	MUG 48	RAL 9005	PG 48	70	8	10

Bucins Plásticos - Porcas Plásticas - Wiska



BUCIM PLÁSTICO - TIPO ESKV



RAL 7035



RAL 9005



RAL 7001

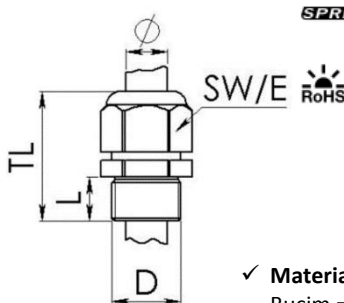

SPRINT



UL US

hätogén

RoHS



- ✓ Material:
Bucim = Poliamida, Junta = EPDM
- ✓ Temperatura admissível: -40° C - +100° C

Código	Referência	Tipo	Cor	L (mm)	D (mm)	Ø Cabo (mm)	SW (mm)	TL (mm)	
477010510	10066410	ESKV 12	RAL 7035	9	M 12x1,5	3-7	16	29-34	50
477010511	10066411	ESKV 16	RAL 7035	9	M 16x1,5	4,5-10	20	31-37	50
477010512	10066412	ESKV 20	RAL 7035	10	M 20x1,5	6-13	24	36-45	50
477010513	10066413	ESKV 25	RAL 7035	10	M 25x1,5	9-17	29	38-47	50
477010514	10066414	ESKV 32	RAL 7035	12	M 32x1,5	13-21	36	42-51	25
477010515	10066415	ESKV 40	RAL 7035	12	M 40x1,5	16-28	46	52-65	10
477010516	10066416	ESKV 50	RAL 7035	14	M 50x1,5	21-35	55	59-72	4
477010517	10066417	ESKV 63	RAL 7035	15	M 63x1,5	34-48	68	64-78	3
477010518	10066120	ESKV 12	RAL 9005	9	M 12x1,5	3-7	16	29-34	50
477010519	10066121	ESKV 16	RAL 9005	9	M 16x1,5	4,5-10	20	31-37	50
477010520	10066122	ESKV 20	RAL 9005	10	M 20x1,5	6-13	24	36-45	50
477010521	10066123	ESKV 25	RAL 9005	10	M 25x1,5	9-17	29	38-47	50
477010522	10066124	ESKV 32	RAL 9005	12	M 32x1,5	13-21	36	42-51	25
477010523	10066125	ESKV 40	RAL 9005	12	M 40x1,5	16-28	46	52-65	10
477010524	10066126	ESKV 50	RAL 9005	14	M 50x1,5	21-35	55	59-72	4
477010525	10066127	ESKV 63	RAL 9005	15	M 63x1,5	34-48	68	64-78	3
477010481	10066380	ESKV 12	RAL 7001	9	M 12x1,5	3-7	16	29-34	50
4770104821	10066381	ESKV 16	RAL 7001	9	M 16x1,5	4,5-10	20	31-37	50
477010483	10066382	ESKV 20	RAL 7001	10	M 20x1,5	6-13	24	36-45	50
4770105131	10066383	ESKV 25	RAL 7001	10	M 25x1,5	9-17	29	38-47	50
4770105221	10066384	ESKV 32	RAL 7001	12	M 32x1,5	13-21	36	42-51	25
--	10066385	ESKV 40	RAL 7001	12	M 40x1,5	16-28	46	52-65	10
4770105161	10066386	ESKV 50	RAL 7001	14	M 50x1,5	21-35	55	59-72	4
--	10066387	ESKV 63	RAL 7001	15	M 63x1,5	34-48	68	64-78	3

Bucins Plásticos - Porcas Plásticas - Wiska



PORCA PLÁSTICO HEXAGONAL - TIPO EMUG



RAL 7035

RAL 9005

RAL 7001

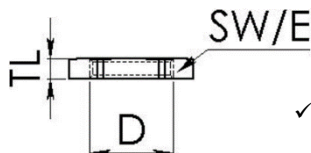

SPRINT

halogen



- ✓ Material: Poliamida reforçada com fibra
- ✓ Temperatura admissível: -40° C +100° C

Código	Referência	Tipo	Cor	D (mm)	SW (mm)	TL (mm)	
--	10060770	EMUG 12	RAL 7035	M 12x1,5	18	5	100
477011541	10060771	EMUG 16	RAL 7035	M 16x1,5	22	5	100
477011542	10060772	EMUG 20	RAL 7035	M 20x1,5	27	5	100
477011543	10060773	EMUG 25	RAL 7035	M 25x1,5	32	6	100
477011544	10060774	EMUG 32	RAL 7035	M 32x1,5	40	6	100
477011545	10060775	EMUG 40	RAL 7035	M 40x1,5	50	7	50
477011546	10060776	EMUG 50	RAL 7035	M 50x1,5	60	7	25
477011547	10060777	EMUG 63	RAL 7035	M 63x1,5	75	7	10
477011548	10061780	EMUG 12	RAL 9005	M 12x1,5	18	5	100
477011549	10061781	EMUG 16	RAL 9005	M 16x1,5	22	5	100
477011550	10061782	EMUG 20	RAL 9005	M 20x1,5	27	5	100
477011551	10061783	EMUG 25	RAL 9005	M 25x1,5	32	6	100
477011552	10061784	EMUG 32	RAL 9005	M 32x1,5	40	6	100
477011553	10061785	EMUG 40	RAL 9005	M 40x1,5	50	7	50
--	10061786	EMUG 50	RAL 9005	M 50x1,5	60	7	25
477011555	10061787	EMUG 63	RAL 9005	M 63x1,5	75	7	10
--	10062712	EMUG 12	RAL 7001	M 12x1,5	18	5	100
--	10062713	EMUG 16	RAL 7001	M 16x1,5	22	5	100
--	10062714	EMUG 20	RAL 7001	M 20x1,5	27	5	100
4770115431	10062715	EMUG 25	RAL 7001	M 25x1,5	32	6	100
4770115441	10062716	EMUG 32	RAL 7001	M 32x1,5	40	6	100
--	10062717	EMUG 40	RAL 7001	M 40x1,5	50	7	50
4770115461	10062718	EMUG 50	RAL 7001	M 50x1,5	60	7	25
--	10062719	EMUG 63	RAL 7001	M 63x1,5	75	7	10

Bucins Metálicos - Porcas Metálicas - Wiska



BUCIM METÁLICO CILÍNDRICO COM BASE HEXAGONAL- TIPO SMKV

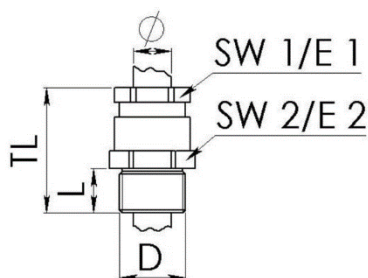

- ✓ **Material:** Bucim = Latão niquelado, Junta = borracha macia
- ✓ **Temperatura admissível:** -40° C +70° C

Código	Referência	Tipo	D (mm)	L (mm)	Ø Cabo (mm)	SW 1 (mm)	SW 2 (mm)	TL (mm)	
477020100	10062061	SMKV 7	PG 7	5	5-7	13	14	20,5	100
477020101	10062082	SMKV 9	PG 9	6	4-11	15	17	22	100
477020102	10062083	SMKV 11	PG 11	6	6,5-13,5	18	20	24	50
477020103	10062084	SMKV 13,5	PG 13,5	6,5	6,5-13,5	20	22	26	50
477020104	10062085	SMKV 16	PG 16	6,5	6,5-16	22	24	26,5	50
477020105	10062086	SMKV 21	PG 21	7	9-20	28	30	30	50
477020106	10062087	SMKV 29	PG 29	8	17-28	37	40	32	25
477020107	10062088	SMKV 36	PG 36	9	23-34	47	50	39	10
477020108	10062089	SMKV 42	PG 42	10	29-40	54	57	44	10
477020109	10062090	SMKV 48	PG 48	10	35-46	60	64	45	10

PORCA METÁLICA HEXAGONAL- TIPO MMU

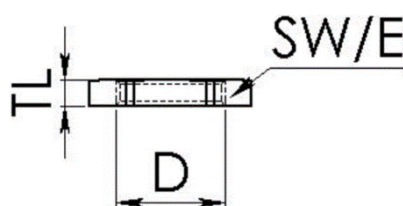

- ✓ **Material:** Latão niquelado

Código	Referência	Tipo	D (mm)	Ø Cabo SW (mm)	TL (mm)	
477021100	10062141	MMU 7	PG 7	15	2,8	100
477021101	10062142	MMU 9	PG 9	18	2,8	100
477021102	10062143	MMU 11	PG 11	21	3	100
477021103	10062144	MMU 13,5	PG 13,5	23	3	100
477021104	10062145	MMU 16	PG 16	26	3	100
477021105	10062146	MMU 21	PG 21	32	3,5	100
477021106	10062147	MMU 29	PG 29	41	4	100
477021107	10062148	MMU 36	PG 36	51	5	100
477021108	10062149	MMU 42	PG 42	60	5	50
477021109	10062150	MMU 48	PG 48	64	5	50

Bucins Metálicos - Porcas Metálicas - Wiska



BUCIM METÁLICO PARA CABO-ROSCA MÉTRICA - TIPO EMSKV

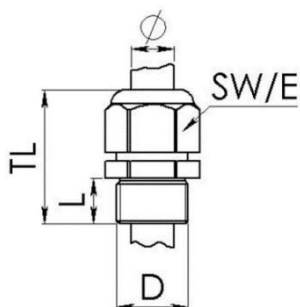

- ✓ Material: Bucim = Latão niquelado, Junta = EPDM
- ✓ Temperatura admissível: -40° C +100° C

Código	Referência	Tipo	D (mm)	L (mm)	Ø Cabo (mm)	SW 1 (mm)	TL (mm)	
477020200	10065000	EMSKV 12	M 12x1,5	5	3-7	16	23-30	50
477020201	10065001	EMSKV 16	M 16x1,5	5	4,5-10	20	26-34	50
477020202	10065002	EMSKV 20	M 20x1,5	6	6-13	24	29-37	50
477020203	10065003	EMSKV 25	M 25x1,5	7	9-17	29	33-42	50
--	10065004	EMSKV 32	M 32x1,5	8	13-21	36	36-44	25
--	10065005	EMSKV 40	M 40x1,5	8	16-28	46	44-55	10
--	10065006	EMSKV 50	M 50x1,5	9	21-35	55	51-62	10
--	10065007	EMSKV 63	M 63x1,5	10	34-48	68	56-67	10
477020208	10100865	EMSKV 75	M 75x1,5	12	48-62	82	67-81	1

Nota: Também disponível modelo "Bucim Metálico para Cabo-Rosca Longa" Tipo EMSKV-L!

Nota: Também disponível modelo "Bucim Metálico com Porca" Tipo EMSKV-SET-12!

PORCA METÁLICA HEXAGONAL- TIPO EMMU

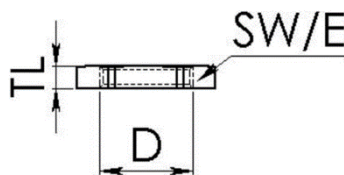

- ✓ Material: Latão niquelado

Código	Referência	Tipo	D (mm)	Ø Cabo SW (mm)	TL (mm)	
--	10106828	EMMU 8	M 8x1,25	11	2,5	100
477021091	10063141	EMMU 12	M 12x1,5	15	2,8	100
477021092	10063142	EMMU 16	M 16x1,5	19	2,8	100
477021093	10063143	EMMU 20	M 20x1,5	24	3	100
477021094	10063144	EMMU 25	M 25x1,5	30	3,5	100
477021095	10063145	EMMU 32	M 32x1,5	36	4	100
477021096	10063146	EMMU 40	M 40x1,5	46	5	50
477021097	10063147	EMMU 50	M 50x1,5	60	5	250
477021098	10063148	EMMU 63	M 63x1,5	70	6	50
477021099	10101777	EMMU 75	M 75x1,5	80	8	1

Bucins Tipo VentGLAND® - Wiska



BUCIM PLÁSTICO, MÉTRICO - SPRINT® ESGV, VentGLAND® - EN 62444



SPRINT

halogen



- ✓ **Material:** Bucim = Poliamida, Junta = EPDM, Membrana = ePTFE
- ✓ **Temperatura admissível:**
-40° C +100° C

BUCIM DE LATÃO, MÉTRICO - SPRINT® EMSVG, VENTGLAND® - EN 62444



SPRINT

halogen



- ✓ **Material:** Bucim = Latão niquelado, Junta = EPDM, Membrana = ePTFE
- ✓ **Temperatura admissível:**
-40° C +100° C

BUCIM DE AÇO INOX A2 ou A4, MÉTRICO - ESSVG, VENTGLAND® - EN 62444



SPRINT

halogen



- ✓ **Material:** Bucim = Aço Inox A2 ou A4, Junta = EPDM, Membrana = ePTFE
- ✓ **Temperatura admissível:**
-40° C +100° C

Nota: Outros modelos sob consulta!

Tampão Plástico Tipo EVSG - Wiska

WISKA 
make power smile



RAL 7035

RAL 7001

RAL 9005

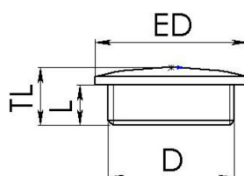

- ✓ **Material:**
Poliamida reforçada com fibra
- ✓ **Temperatura admissível:**
-40° C +100° C

Código	Referência	Tipo	Cor	D (mm)	L (mm)	TL (mm)	
--	10060624	EVSG 12	RAL 7035	M 12x1,5	6	8	100
--	10060625	EVSG 16	RAL 7035	M 16x1,5	6	9	100
477310613	10060626	EVSG 20	RAL 7035	M 20x1,5	6	9,5	100
477310614	10060627	EVSG 25	RAL 7035	M 25x1,5	8	11,5	100
--	10060628	EVSG 32	RAL 7035	M 32x1,5	8	12	100
477310616	10060629	EVSG 40	RAL 7035	M 40x1,5	8	13	50
477310617	10060630	EVSG 50	RAL 7035	M 50x1,5	10	15	50
477310618	10060631	EVSG 63	RAL 7035	M 63x1,5	12	17	25
--	10061830	EVSG 12	RAL 9005	M 12x1,5	6	8	100
477310621	10061831	EVSG 16	RAL 9005	M 16x1,5	6	9	100
477310663	10061832	EVSG 20	RAL 9005	M 20x1,5	6	9,5	100
477310664	10061833	EVSG 25	RAL 9005	M 25x1,5	8	11,5	100
--	10061834	EVSG 32	RAL 9005	M 32x1,5	8	12	100
--	10061835	EVSG 40	RAL 9005	M 40x1,5	8	13	50
--	10061836	EVSG 50	RAL 9005	M 50x1,5	10	15	50
477310619	10061837	EVSG 63	RAL 9005	M 63x1,5	12	17	25
--	10062514	EVSG 12	RAL 7001	M 12x1,5	6	8	100
--	10062515	EVSG 16	RAL 7001	M 16x1,5	6	9	100
--	10062516	EVSG 20	RAL 7001	M 20x1,5	6	9,5	100
--	10062517	EVSG 25	RAL 7001	M 25x1,5	8	11,5	100
--	10062518	EVSG 32	RAL 7001	M 32x1,5	8	12	100
--	10062519	EVSG 40	RAL 7001	M 40x1,5	8	13	50
--	10062520	EVSG 50	RAL 7001	M 50x1,5	10	15	50
--	10062521	EVSG 63	RAL 7001	M 63x1,5	12	17	25

Caixas de Derivação - Wiska

WISKA 
make power smile



- ✓ As caixas de derivação **COMBI**® para aplicações em interior e exterior!
- ✓ **Material:** Polipropileno, Junta = TPE
- ✓ Proteção contra humidade e pó!
- ✓ Formato da tampa permite mais 10% de espaço!
- ✓ Instalação rápida!
- ✓ Fecho rápido e seguro!
- ✓ Sem parafusos metálicos!
- ✓ Rosca integrada na qual os buçins podem ser montados diretamente - sem porcas de fixação!
- ✓ Disponíveis com tampa preta ou tampa de cor diferente, exemplo: transparente, azul, vermelha, verde, etc.!
- ✓ As caixas de junção COMBI são usadas em aplicações comerciais, industriais e domésticas, como indústrias ferroviárias, marítimas e offshore!

Caixas de Derivação - Wiska





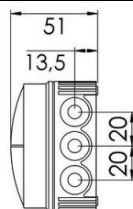
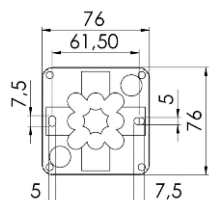



WISKA 
make power smile

COMBI® 108

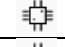
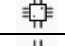
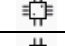

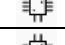
- ✓ Terminais / polos: 4 mm²
- ✓ Tensão: 400V
- ✓ Temperatura admissível: -30°C - +100°C
- ✓ Temperatura de instalação -5 °C - +60° C







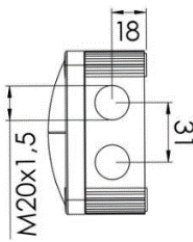
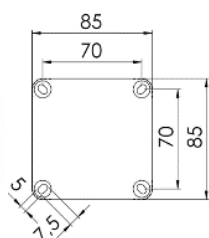



Código	Referência	Tipo	Cor		
477000100	10060522	COMBI® 108/empty	RAL 7035		10
--	10061999	COMBI® 108/empty/S	RAL 9005		10
--	10060622	COMBI® 108/empty/W	RAL 9001		10
--	10060632	COMBI® 108/empty/DR	--		10
--	10061974	COMBI® 108/empty/SMB	RAL 7035		10
--	10060523	COMBI® 108/5 - com bloco de terminais de 5 polos	RAL 7035		10
--	10061998	COMBI® 108/5/S - com bloco de terminais de 5 polos	RAL 9005		10
--	10060623	COMBI® 108/5/W - com bloco de terminais de 5 polos	RAL 9001		10

COMBI® 308

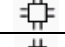
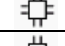
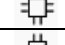

- ✓ Terminais / polos: 2,5 mm²
- ✓ Tensão: 400V
- ✓ Temperatura admissível: -30°C - +100°C
- ✓ Temperatura de instalação -5 °C - +60° C



Código	Referência	Tipo	Cor		
477000120	10060400	COMBI® 308/empty	RAL 7035		5
477000121	10060581	COMBI® 308/empty/S	RAL 9005		5
--	10060610	COMBI® 308/empty/W	RAL 9001		5
--	10060480	COMBI® 308/empty/DR	--		5
477000122	10060401	COMBI® 308/5 - com bloco de terminais de 5 polos	RAL 7035		5
--	10060580	COMBI® 308/5/S - com bloco de terminais de 5 polos	RAL 9005		5
--	10060611	COMBI® 308/5/W - com bloco de terminais de 5 polos	RAL 9001		5
--	10107390	COMBI® 308/5/DR - com bloco de terminais de 5 polos	--		5

Caixas de Derivação - Wiska





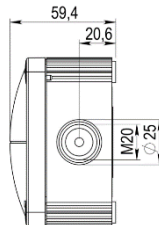
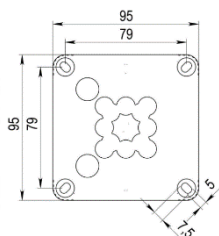

WISKA 
make power smile

COMBI® 407

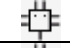
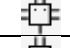

- ✓ Terminais / polos: 4 mm²
- ✓ Tensão: 690V
- ✓ Temperatura admissível: -30°C - +100°C
- ✓ Temperatura de instalação -5 °C - +60° C

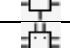
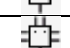
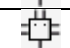
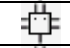





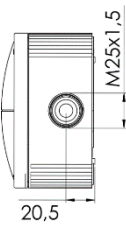
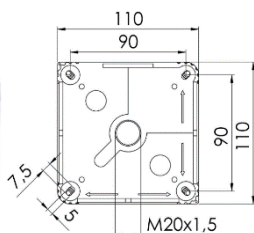



Código	Referência	Tipo	Cor		
477000130	10105595	COMBI® 407/empty	RAL 7035		5
--	10105596	COMBI® 407/5 - com bloco de terminais de 5 polos	RAL 7035		5
--	10105597	COMBI® 407/SDK5 - com bloco de terminais de 5 polos	RAL 7035		5
--	10105598	COMBI® 407/empty/W	RAL 9001		5
--	10105599	COMBI® 407/5/W - com bloco de terminais de 5 polos	RAL 9001		5
--	10105600	COMBI® 407/SDK5/W - com bloco de terminais de 5 polos	RAL 9001		5
--	10105601	COMBI® 407/empty/S	RAL 9005		5
--	10105602	COMBI® 407/5/S - com bloco de terminais de 5 polos	RAL 9005		5
--	10105603	COMBI® 407/SDK5/S - com bloco de terminais de 5 polos	RAL 9005		5

COMBI® 607

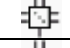

- ✓ Terminais / polos: 6 mm²
- ✓ Tensão: 690V
- ✓ Temperatura admissível: -30°C - +100°C
- ✓ Temperatura de instalação -5 °C - +60° C

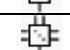
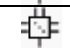

Código	Referência	Tipo	Cor		
477000140	10060531	COMBI® 607/empty	RAL 7035		3
	10060648	COMBI® 607/empty/S	RAL 9005		3
	10060533	COMBI® 607/empty/W	RAL 9001		3
477000141	10060532	COMBI® 607/5 - com bloco de terminais de 5 polos	RAL 7035		3
	10060538	COMBI® 607/5/S - com bloco de terminais de 5 polos	RAL 9005		3
	10060534	COMBI® 607/5/W - com bloco de terminais de 5 polos	RAL 9001		3
	10060537	COMBI® IND 607/empty	RAL 7035		3
	10060519	COMBI® IND 607/5 - com bloco de terminais de 5 polos	RAL 7035		3

Caixas de Derivação - Wiska





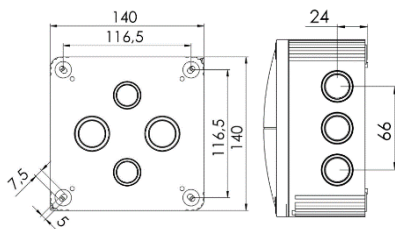



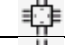

WISKA 
make power smile

COMBI® 1010



- ✓ Terminais / polos: 10 mm²
- ✓ Tensão: 690V
- ✓ Temperatura admissível: -30°C - +100°C
- ✓ Temperatura de instalação -5 °C - +60° C



Código	Referência	Tipo	Cor		
477000170	10060702	COMBI® 1010/empty	RAL 7035		2
--	10062214	COMBI® 1010/empty/S	RAL 9005		2
--	10062210	COMBI® 1010/empty/W	RAL 9001		2
--	10060703	COMBI® 1010/5 - com bloco de terminais de 5 polos	RAL 7035		2
--	10062215	COMBI® 1010/5/S - com bloco de terminais de 5 polos	RAL 9005		2
--	10062211	COMBI® 1010/5/W - com bloco de terminais de 5 polos	RAL 9001		2
--	10060704	COMBI® IND 1010/empty	RAL 7035		2
--	10060705	COMBI® IND 1010/5 - com bloco de terminais de 5 polos	RAL 7035		2

Nota: Caixas COMBI® - outros tamanhos sob consulta!



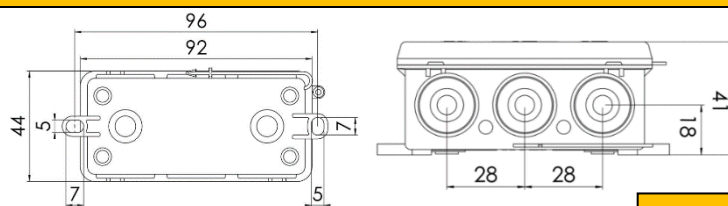

KA 6



Polietileno / Polipropileno

- ✓ Terminais / polos: 1,5 mm²
- ✓ Tensão: 400V
- ✓ Temperatura admissível: -30°C - +60°C
- ✓ Temperatura de instalação -5 °C - +60° C

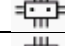



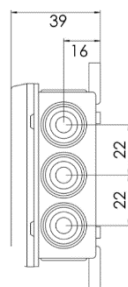
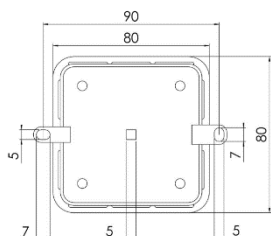

Código	Referência	Tipo	Cor	 (mm)		
477000180	10060818	KA 6/empty	RAL 7035	8-13		10
477000181	10060819	KA 6/empty/W	RAL 9005	8-13		10
477000182	10060861	KA 6/5 - com bloco de terminais de 5 polos	RAL 7035	8-13		10

Caixas de Derivação - Wiska



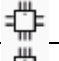
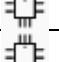
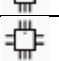
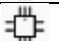

KA 12

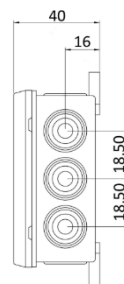
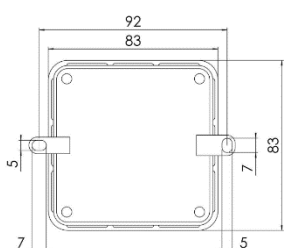
Polietileno / Polipropileno

- ✓ Terminais / polos: 2,5 mm²
- ✓ Tensão: 400V
- ✓ Temperatura admissível: -30°C - +60°C
- ✓ Temperatura de instalação -5 °C - +60° C

Código	Referência	Tipo	Cor	 (mm)		
477000185	10060822	KA 12/empty	RAL 7035	7-13		10
--	10060490	KA 12/empty/W	RAL 9005	7-13		10
--	10060825	KA 12/empty/R	RAL 3000	7-13		10
477000188	10060821	KA 12/5 - com bloco de terminais de 5 polos	RAL 7035	7-13		10
--	10060824	KA 12/5/R - com bloco de terminais de 5 polos	RAL 3000	7-13		10

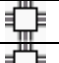
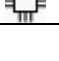
KA 14

Polietileno / Polipropileno

- ✓ Terminais / polos: 2,5 mm²
- ✓ Tensão: 400V
- ✓ Temperatura admissível: -30°C - +60°C
- ✓ Temperatura de instalação -5 °C - +60° C



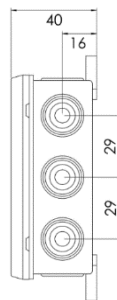
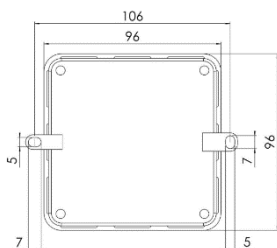

Código	Referência	Tipo	Cor	 (mm)		
477000190	10060550	KA 14/empty	RAL 7035	7-13		10
--	10060551	KA 14/5 - com bloco de terminais de 5 polos	RAL 7035	7-13		10

Caixas de Derivação - Wiska

WISKA
 make power smile

KA 16

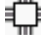
Polietileno / Polipropileno

- ✓ Terminais / polos: 4 mm²
- ✓ Tensão: 400V
- ✓ Temperatura admissível: -30°C - +60°C
- ✓ Temperatura de instalação -5 °C - +60 °C

Código	Referência	Tipo	Cor	 (mm)		
--	10060554	KA 16/empty	RAL 7035	7-13		10
--	10060554	KA 16/5 - com bloco de terminais de 5 polos	RAL 7035	7-13		10

União de Cabos - Wiska





788/SKV

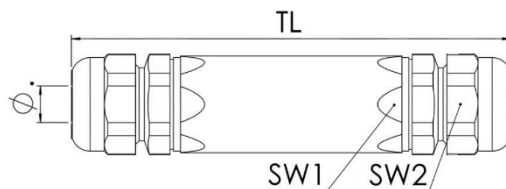

✓ Temperatura admissível: -25°C - +60°C

Polistireno ignífugo
Bucim: Poliamida



Código	Referência	Tipo	Cor	SW1 (mm)	SW2 (mm)	TL (mm)	 (mm)	
477002350	10061462	788/SKV 16 Terminais / polos: 5 x 2,5 mm ²	RAL 7035	26	27	134	8-14	15
--	10061436	788/6/SKV 21 Terminais / polos: 5 x 6,0 mm ²	RAL 7035	32	33	165	10-18	10

Material Ex - Marítimo - Wiska



ARMADURA DE LATÃO - EX

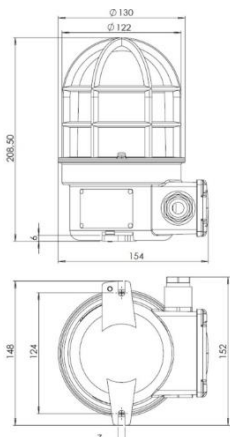

Aprovações:

IECEx EPS 17.0060X, EPS 17 ATEX 1 120 X

- ✓ **Material:** Latão
- ✓ **Casquilho:** E27
- ✓ Tipo de buçim: M24x1,5 Z 14 / 12-14,5mm
- ✓ Globo: Vidro transparente
- ✓ Lâmpada: Incandescente, LED, fluorescente (lâmpada não incluída)
- ✓ Tensão: 230 V AC, Tensão máxima: 250 V AC
- ✓ Frequência: 50/60 Hz
- ✓ Área operacional: Proteção contra explosões
- ✓ Temperatura admissível: -40°C - +55°C

Código	Referência	Tipo
4778EX0525	Ex-525/1x24-Z14 - 10109148	Armadura Latão Casquilho E27 - EX

Material Ex - Marítimo - Wiska



ARMADURA DE LATÃO - Ex

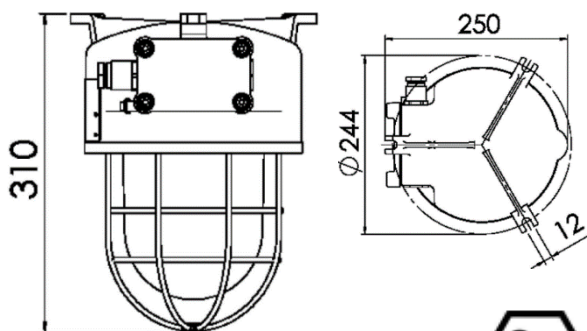

- ✓ **Material:** Latão
- ✓ **Casquilho:** B22d
- ✓ Tipo de bucim: M24x1,5 Z 14 / 12-14,5mm
- ✓ Globo: Vidro transparente
- ✓ Lâmpada não incluída
- ✓ Tensão: 230 V AC, Tensão máxima: 250 V AC
- ✓ Frequência: 50/60 Hz
- ✓ Área operacional: Proteção contra explosões IIC
- ✓ Temperatura admissível: -40°C - +55°C

Aprovações:

IECEx TUR 15.0022X, TÜV 14 ATEX 7567 X

Código	Referência	Tipo
--	Ex-3312/D/B22/2x24-Z14 - 10031257	Armadura Latão Casquilho B22d - Ex

Material Ex - Marítimo - Wiska



INTERRUPTOR DE LATÃO - Ex

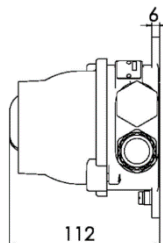
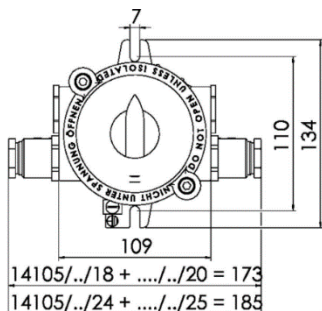

- ✓ **Material:** Latão
- ✓ Tipo de buçim: M24x1,5
- ✓ Tensão: 690 V / 16 A
- ✓ Grupos de explosão: IIC, IIIC
- ✓ Temperatura admissível: -40°C - +55°C



Aprovações:

TÜV 14 ATEX 7568 X, IECEx TUR 15.0017X

Código	Referência	Tipo
4778EX0141052	Ex-14105/1x24-Z14 - 10030504	Interruptor de latão - Ex

CAIXA DE LATÃO - Ex

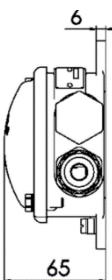
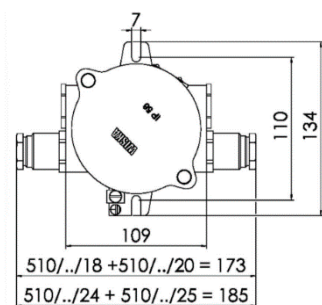

IP56



- ✓ **Material:** Latão
- ✓ Tipo de buçim: M24x1,5
- ✓ Tensão: 690 V
- ✓ Área operacional: Proteção contra explosões
- ✓ Grupos de explosão: II
- ✓ Temperatura admissível: -50°C - +100°C

Aprovação: GL

Código	Referência	Tipo
4778EX0510D	Ex-510/D/2x24-Z14 - 10030254	Caixa de latão - Ex

Material Marítimo - Wiska



SINALIZADOR DE LATÃO – TIPO HNA

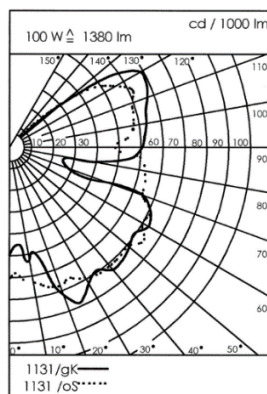
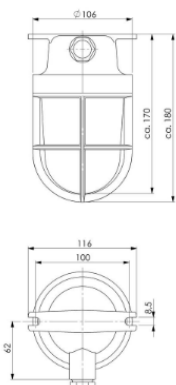

IP56

- ✓ **Material:** Latão, globo = vidro - disponível em várias cores!
- ✓ **Casquilho:** E27
- ✓ Tipo de bucim: M24x1,5 Z 14 / 12-14,5mm
- ✓ Globo: Vidro transparente
- ✓ Lâmpada: incandescente (lâmpada não incluída)
- ✓ 100 W / 230 V AC
- ✓ Temperatura admissível: -25°C - +45°C

Código	Referência	Tipo
477800002	10112660	Sinalizador SB/S-VM IP56 com Casquilho E27 1131/gK/1974

Nota: Várias entradas de cabo disponíveis!

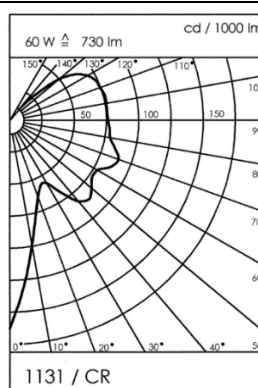
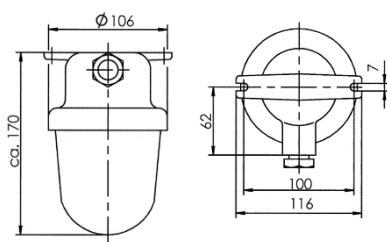

IP56

- ✓ **Material:** Latão, globo = Policarbonato - disponível em várias cores!
- ✓ **Casquilho:** E27
- ✓ Tipo de bucim: M24x1,5 Z 14 / 12-14,5mm
- ✓ Globo: Vidro transparente
- ✓ Lâmpada: incandescente (lâmpada não incluída)
- ✓ 60 W / 230 V AC
- ✓ Temperatura admissível: -25°C - +45°C

Código	Referência	Tipo
4778M01131CR1	10014304	Sinalizador/Armadura Latão HNA IP56 1131/CR/clear/mT/1975 - 10014304

Nota: Várias entradas de cabo disponíveis!

Material Marítimo - Wiska



SINALIZADOR PLANO DE TETO DE LATÃO

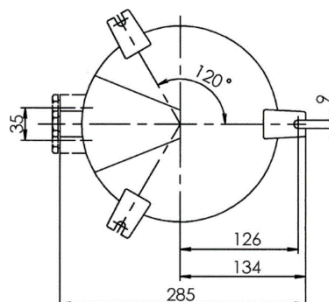
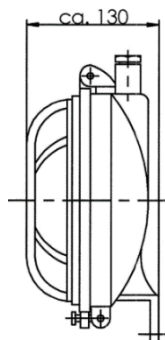

IP56

- ✓ **Material:** Latão, globo = vidro
- ✓ **Casquilho:** E27
- ✓ Tipo de bucim: M24x1,5 Z 14 / 12-14,5mm
- ✓ Globo: Vidro transparente
- ✓ Lâmpada: incandescente (lâmpada não incluída)
- ✓ 100 W / 230 V AC
- ✓ Temperatura admissível: -25°C - +45°C

Código	Referência	Tipo
4778M010261974	10012989	Armadura Latão - 1026/1974-1xZ14 - 10012989

Nota: Várias entradas de cabo disponíveis!

Material Marítimo - Wiska



INTERRUPTOR DE LATÃO – TIPO HNA

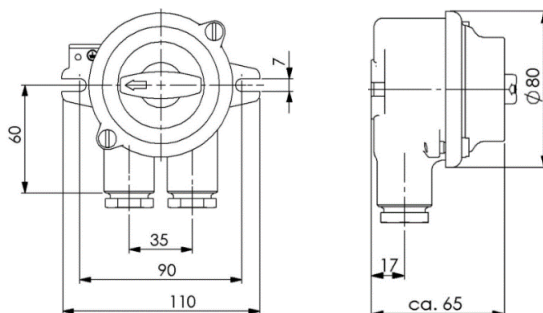

IP56

DIN 9270

- ✓ **Material:** Latão
- ✓ 250 V
- ✓ Tipo de bucim: M24 x 1,5, Ø cabo 10 – 14,5mm
- ✓ Temperatura admissível: -25°C - +45°C

Código	Referência	Tipo
4778E011332P	10010532	Interruptor Latão HNA IP 56 250V/10A - 1133/2/P
4778E01133P	10010531	Interruptor Latão HNA IP 56 250V/10A - 1133/P
4778E01133WE	10010541	Interruptor Latão HNA IP 56 250V/10A - 1133/WE
4778E01138P	10010535	Interruptor Latão HNA IP 56 250V/10A - 1138/P

Nota: Várias entradas de cabo disponíveis!

TOMADA DE LATÃO – TIPO HNA

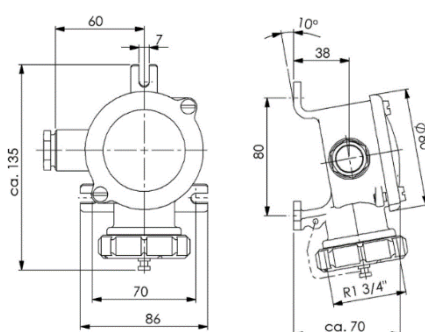

DIN 9262

IP56

- ✓ **Material:** Latão
- ✓ Tipo de bucim: M24 x 1,5, Ø cabo 12–14,5mm
- ✓ 150 V AC / 16 A
- ✓ Temperatura admissível: -25°C - +40°C

Código	Referência	Tipo
477850113	10010573	Tomada Latão HNA IP 56 250V/16A - 1141/2
4778E01141L	10010581	Tomada com Tampa Latão HNA IP56250V/16A - 1141/250V/MS
4778E01141R	10010572	Tomada Latão HNA IP 56 250V/16A - 1141/R
4778E01141RL	10010582	Tomada com Tampa Latão HNA IP56250V/16A - 1141/R/250V/MS

Nota: Várias entradas de cabo disponíveis!

Material Marítimo - Wiska



FICHA DE LATÃO – TIPO HNA

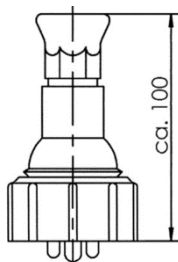

- ✓ **Material:** Latão
- ✓ Tipo de buçim: M24 x 1,5
- ✓ Ø Cabo: 8 – 10,5mm
- ✓ 250 V AC / 16 A
- ✓ Temperatura admissível: -25°C - +45°C

DIN 89267



IP56

Código	Referência	Tipo
477800011	1142/V/MS/250V-1xW10 - 10010695	Ficha de latão HNA
477800012	1142/MS/250V-1Xw10 - 10010677	Ficha de latão HNA

FICHA DE PLÁSTICO - TIPO HNA

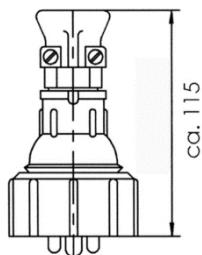

- ✓ **Material:** Plástico – RAL 7035
- ✓ Tipo de buçim: M24 x 1,5
- ✓ Ø Cabo: 8 – 10,5mm
- ✓ 250 V AC / 16 A
- ✓ Temperatura admissível: -25°C - +45°C

DIN 89267



IP56

Código	Referência	Tipo
4778E1142FS	1142/FS/250V-1xW10 - 10010676	Ficha de plástico HNA

FICHA CONCÊNTRICA DE PLÁSTICO

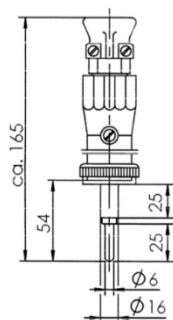

- ✓ **Material:** Poliamida, reforçada com fibra – RAL 7035
- ✓ Tipo de buçim: M24 x 1,5
- ✓ 50 V DC / 10 A
- ✓ Temperatura admissível: -25°C - +45°C



IP56

Código	Referência	Tipo
477800411	117-1xW10A – 10010001	Ficha concêntrica de plástico

Material Marítimo - Wiska



FICHA CONCÊNTRICA FÊMEA DE PLÁSTICO

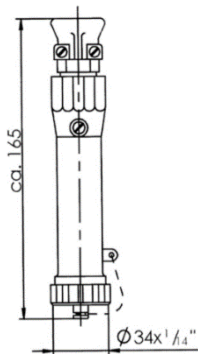

- ✓ **Material:** Poliamida, reforçada com fibra – RAL 7035
- ✓ Tipo de buçim: M24 x 1,5
- ✓ 50 V DC / 10 A
- ✓ Temperatura admissível: -25°C - +45°C



IP56

Código	Referência	Tipo
4778E0122	122-1xW10A - 10010002	Ficha concêntrica fêmea de plástico

Material Marítimo - Wiska



CAIXA DE TOMADAS - VARITAIN®

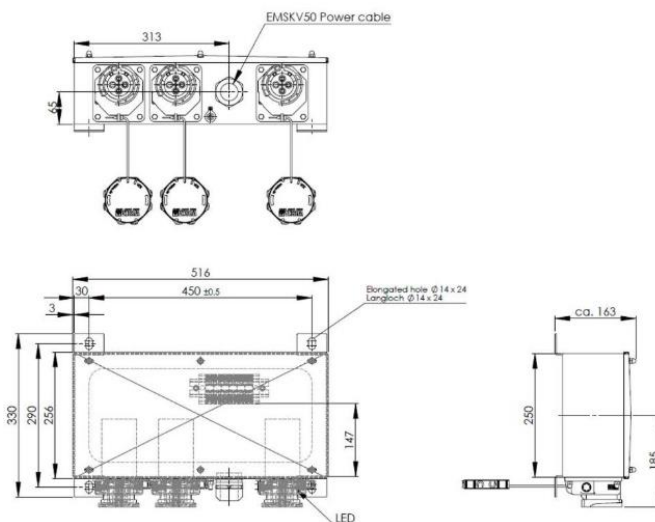

Material: Aço inox 1.4301 (V2A), Capa de proteção: Poliamida; RAL 7035

Utilização: **Exterior**

Capacidade de interrupção: 10 kA

Tensão máxima: 440 V / AC

Corrente: 32 A

Tipo de buçim: EMSKV 50 RDE50/EE45-33

Montagem: Parede, montagem em superfície

Temperatura admissível: -25°C - +45°C

Código	Referência	Tipo
4778V8623	VARITAIN® PI 03/FS/FS/32A/10kA/LED/G - 10108623	Caixa de Tomadas

Nota: Outros modelos sob consulta!

Material Marítimo - Wiska



CAIXA DE TOMADAS - VARITAIN®

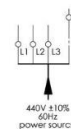
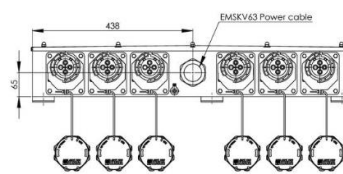
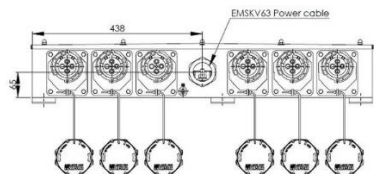

Colour of terminal block			
L1 (R)	Red	Green	Black
L2 (S)	White	Yellow	Brown
L3 (T)	Black	Blue	Grey

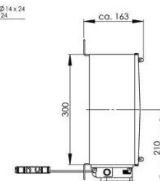
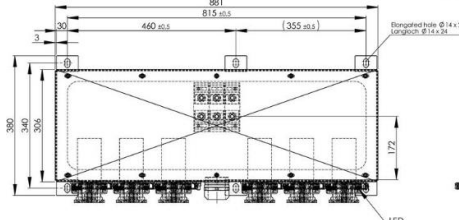
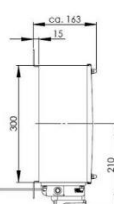
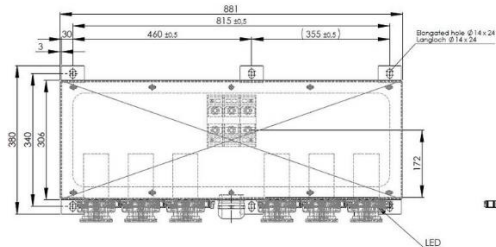

Material: Aço inox 1.4301 (V2A), Capa de proteção: Poliamida; RAL 7035

Utilização: **Exterior**

Capacidade de interrupção: 10 kA

Tensão máxima: 440 V / AC

Corrente: 32 A

Tipo de buçim: EMSKV 63 RDE63/EE56-45

Montagem: Parede, montagem em superfície

Temperatura admissível: -25°C - +45°C

Código	Referência	Tipo
4778V8626	VARITAIN® PI 06/FS/FS/32A/10kA/LED/G - 10108626	Caixa de Tomadas

Nota: Outros modelos sob consulta!



VARITAIN® OneTouch ECO 32A 10kA



VARITAIN® PushIn 32A 25kA



Material Marítimo - Wiska



GLOBO SUBSTITUIÇÃO DA ARMADURA DE SINALIZAÇÃO

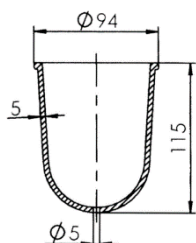

- ✓ Globo de vidro cilíndrico
- ✓ Sem furo
- ✓ Adequado para sinalizadores padrão HNA 1131/gK e luminárias para o convés inferior 1031

Código

Referência

477800005

SP-1900/oT/vermelho - 22000320

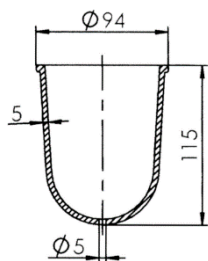

- ✓ Globo de vidro cilíndrico
- ✓ Sem furo
- ✓ Adequado para sinalizadores padrão HNA 1131/gK e luminárias para o convés inferior 1031

Código

Referência

477800004

SP-1900/oT/transparente - 22000318

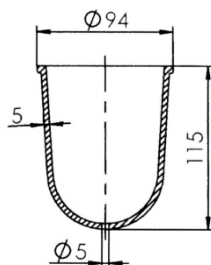

- ✓ Globo de vidro cilíndrico
- ✓ Sem furo
- ✓ Adequado para sinalizadores padrão HNA 1131/gK e luminárias para o convés inferior 1031

Código

Referência

477800006

SP-1900/oT/verde - 22000321

Nota: Outras cores sob consulta!

Nota: Modelo com furo sob consulta!

Material Marítimo - Wiska



PROJETORES / FAROIS DE BUSCA / SINALIZADORES



Nota: Outros modelos sob consulta!